



Propeller air heaters



CIATGAZ MGU air heaters.
Small dimensions,
easy to install.

USES

Self-contained air heaters for industrial and commercial space heating (particularly establishments open to the public). These small units can be installed easily in rooms with low ceilings.

RANGE

3 models (MGU 15, MGU 25 and MGU 35) with a capacity of 16, 25 and 34 kW, respectively.

DESCRIPTION

- RAL 7035 housing with RAL 7024 louvres.
- Stainless steel combustion chamber.
- High-efficiency stainless steel tube atmospheric burner.
- Sealed forced-draught combustion circuit.
- Double baffles as standard (vertical and horizontal).
- May be hung on a wall or suspended from a ceiling as standard.

ACCESSORIES

- Remote control unit with built-in thermostat with a single setpoint or programmable with 1 or 2 stages.
- BUS control.
- Wall bracket.
- Horizontal or vertical coaxial direct vent pipe.



INSTALLATION DIAGRAM

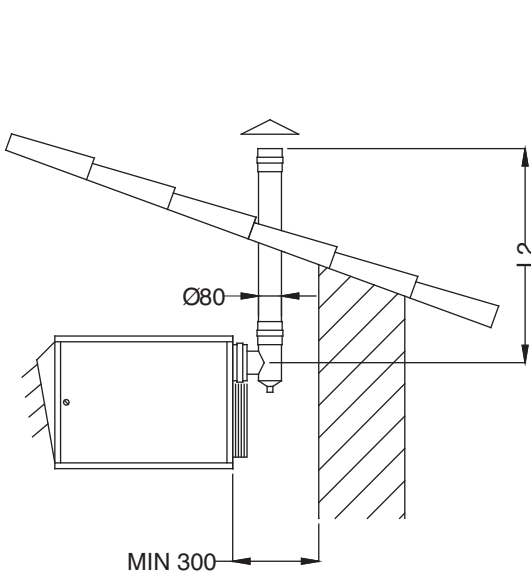
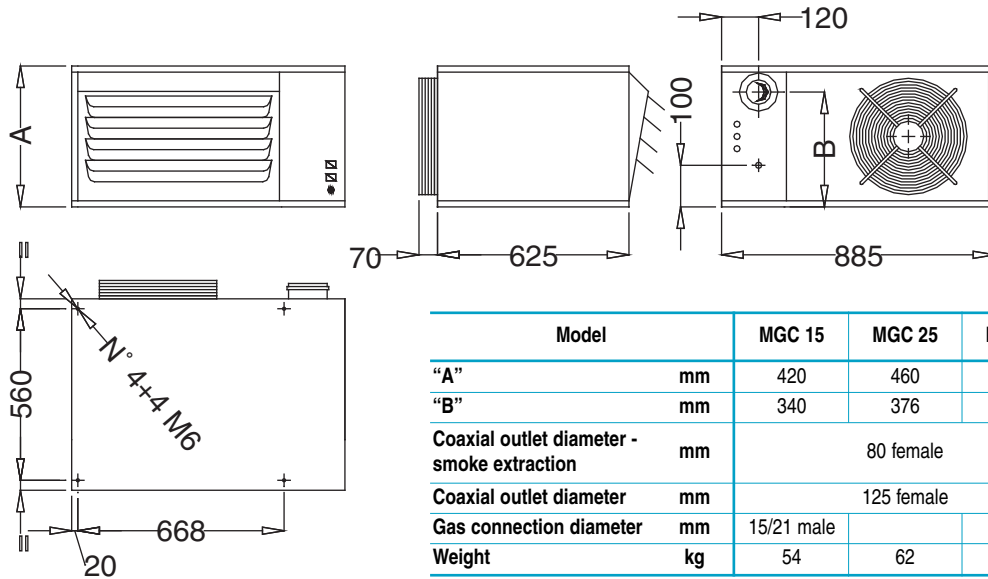

B22: Installation diagram for vertical smoke extraction and combustion air intake into room.

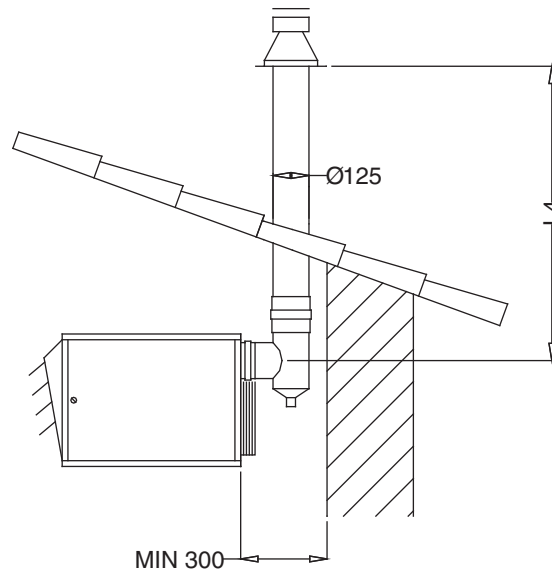

C32: Installation diagram for a vertical coaxial direct vent pipe.

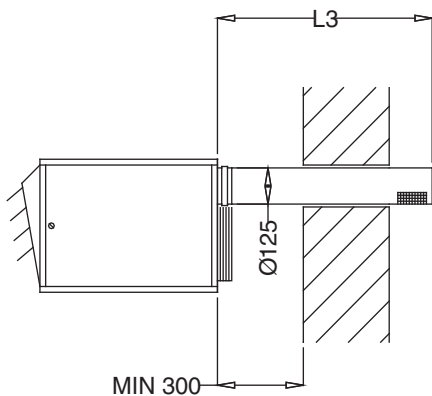

C12: Installation diagram for a horizontal coaxial direct vent pipe.

Direct vent pipe length

CIATGAZ	Minimum			Maximum		
	L2	L3	L4	L2	L3	L4
MGU 15	1	6	3.2	3.2	3.2	3.2
MGU 25	1	6	3.2	3.2	3.2	3.2
MGU 35	1	6	3.2	3.2	3.2	3.2



SPECIFICATIONS

Description			
	Code		
MGU	15	7112042	●
	25	7112047	●
	35	7112048	●

ACCESSORIES

Wall bracket		7112049	●
Remote control unit; off, heating, ventilation; built-in programmable thermostat with single setpoint and 1 or 2 stages with built-in remote reset.		7024383	●
Remote control unit; off, heating, ventilation; built-in programmable thermostat (weekly and daily programs); 1 or 2 stages with built-in remote reset.		7024386	●
Bus with thermostatic control, 1 per zone, 16 units max. (receiver boards)		7112060	●
Receiver board for bus control (1 per unit)		7112061	●
Coaxial direct vent pipe 80/125, horizontal	A	7112062	●
Coaxial direct vent pipe 80/125, vertical	Q	7112063	●
Coaxial tube 80/125 L1000 MF	S	7112064	●
Coaxial tube 80/125 L500 MF	T	7112065	●
90° coaxial elbow 80/125 MF	I	7112068	●
45° coaxial elbow 80/125 MF	H	7112070	●
Coaxial sleeve 80/125 MF L150 with bleed	B	7112073	●
Gaz accessories : see HGU			

DESCRIPTION		MGU 15	MGU 25	MGU 35
Useful heating capacity	kW	16.0	25.0	34.0
Max. output	%	92.5	92	92.5
Airflow at +15°C	Nm³/h	1630	2550	3450
Air discharge range (5)	m	14	17	18
Temperature increase	K	29	29	29
Net smoke temperature	K	~ 120		
Sound pressure level	dB(A)	46.5	52	54.5
Propeller fan	Number	No.	1	1
	Rotation speed	rpm	1400	1370
Single-phase electrical power supply		230 V ~ 50 Hz		
Total Amps	A	0.8	1.2	1.3
Electrical protection	IP	40		
Gas category		II 2H3+		
Installation type		B22 - C12 - C32		
Operating limit	Operating temperature	°C	0 / + 30	
	Max. relative humidity (at 40°C non-condensing)	%	80	
G20 natural gas	Nozzle pressure	mbar	12.5	13
	Consumption (2)	Nm³/h	1.74	2.73
G25 Groningen gas	Nozzle pressure	mbar	12.5	13
	Consumption (6)	Nm³/h	2.02	3.17
G31 propane gas	Nozzle pressure	mbar	36.5	36.5
	Consumption (3)	Nm³/h	0.67	1.05
G30 butane gas	Nozzle pressure	mbar	29.5	29.5
	Consumption (4)	Nm³/h	0.51	0.8

(1) Reference:

- Typical wall installation in a free field
- Measured at a distance of 6 metres from the front

(2) Lower heating value: 8.570 kcal/kg

(3) Lower heating value: 22.360 kcal/kg³ - 11,070 kcal/kg - 5,635 kcal/litre

(4) Lower heating value: 29.330 kcal/m³ - 10.905 kcal/h - 6,285 kcal/litre

(5) 20°C isotherm, 0.1m/sj residual speed

(6) Lower heating value: 7.370 kcal/m³

Value at:

- Atmospheric pressure: 1013 mbar
- Temperature: 15°C